

WYARALONG DAM Competitor Headland

2021 BSRA REGATTA SEASON EVENT DIAGRAM

- A** Entry (Restricted Access Only)
- B** One way circulation (anti clockwise)
- C** Trailer Parking Zone
- D** Competitor tents & logistics trailers – 10 zones (Marked on site)
- E** Rowing Queensland Office - First Aid and Bow numbers
- F** Boat Park – 10 zones (Marked on site)
- G** Out of Bounds
- H** Amenities (Toilets & Water station)
- I** Officials and Emergency parking only
- J** Traffic Control
- K** Boating Area (Launch Access)
- L** Catering & Host School parking
- +** First Aid

No dogs allowed at Wyaralong Dam

ABSOLUTELY NO PARENTS' VEHICLES ALLOWED ON THE COMPETITOR HEADLAND UNDER ANY CIRCUMSTANCES

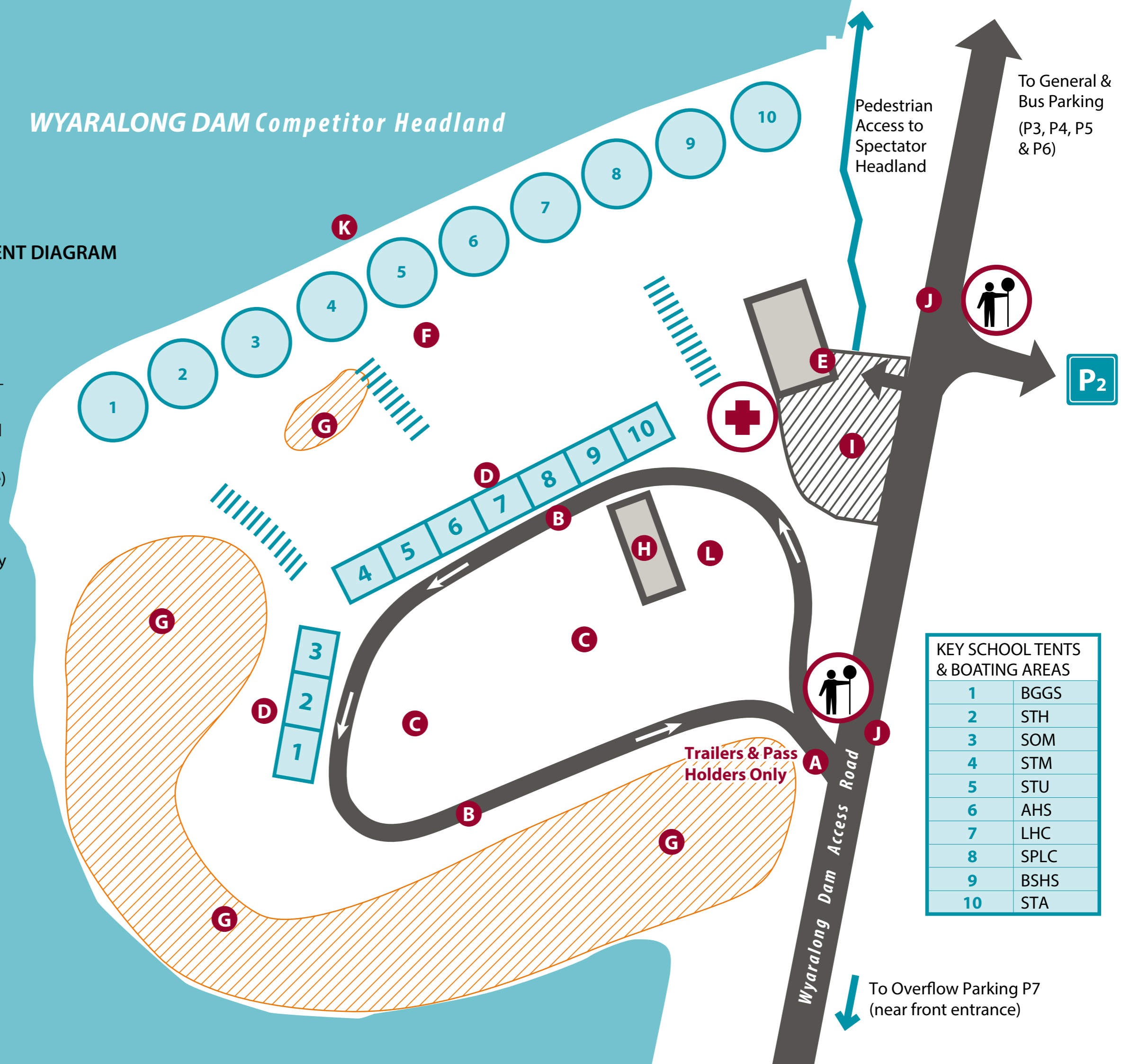

KEY SCHOOL TENTS & BOATING AREAS	
1	BGGS
2	STH
3	SOM
4	STM
5	STU
6	AHS
7	LHC
8	SPLC
9	BSHS
10	STA